



### ● Features

- Low maintenance with high reliability
- Easy installation
- New style mounting plate with increased immobility
- Aluminum anodized casing
- MOV prevents spike and surge current
- Dual voltage 12/24 VDC (auto-switchable)
- Anti-residual magnetism function (ARM)

### ● Statement

GEM-D600 electromagnetic lock uses a new style mounting plate patented. The mounting plate is designed with increased thickness of screw holes in order to provide lock body with more immobility and strength. GEM-D600 can be installed on various types of doors or door frames with different brackets.

### ● Specification

- Operating Voltage: 12/24VDC (auto-switchable)
- Current Draw: 500mA/12VDC; 250mA/24VDC (at 20°C)
- Operating temperature: -10~55°C (14~131°F)
- Humidity: 0~95% non-condensing
- Holding force: up to 600lbs x2 (equivalent of 272kgx2)
- Dimensions:
  - Magnet: (L) 500, (W) 44, (D) 26mm
  - Armature plate: (L) 185, (W) 38, (D) 12mm x2
  - Mounting plate: (L) 500, (W) 26, (D) 5.5mm
- Finish for magnet and armature plate is zinc plated.
- Epoxy potting compound rating: E87252 (S), UL94V-0
- Net Weight: 4.26kg

### ● Dimensions

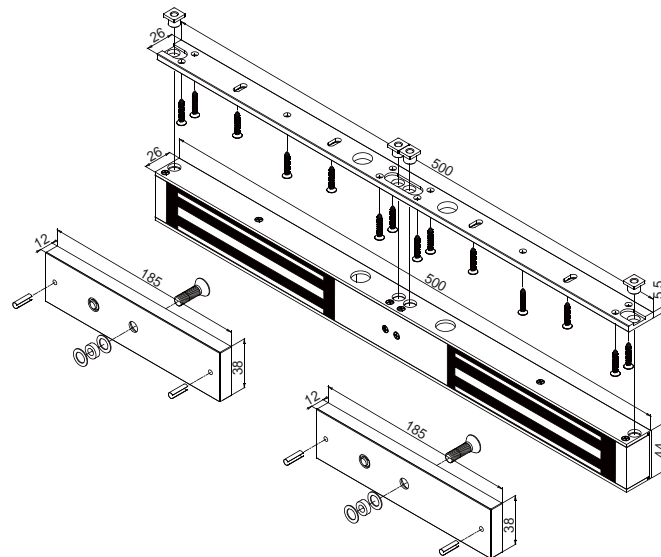

Unit: mm

### ● New style mounting plate (patented)

GEM GEM GEM

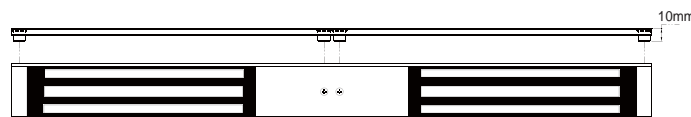

10mm thickness to increase immobility and strength

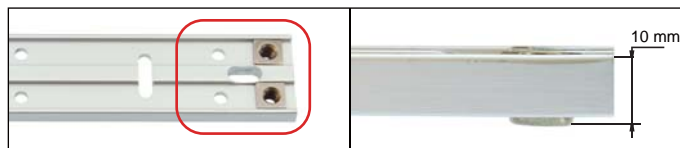

### ● Warranty

The product is warranted against defects in material and workmanship while used in normal service for a period of 5 years from the date of sale to the original customer. The GEM policy is one of continual development and improvement; therefore GEM reserves the right to change specifications without notice.

### GIANNI INDUSTRIES, INC.

### Optional Features



**xxxxx-M:** Bond sensor output  
Indicate the door locking status (locked / unlocked) with a visible LED light, which helps to identify from distance.

Bond sensor output: SPDT rated : 0.5A/120VAC;1A/24VDC

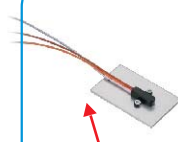

**xxxxx-DS:** Door Status  
Door Status Sensor indicates the door position (open/closed).  
Optional accessories (TLM-100MTS/TLM-200) offer higher security through remote monitoring.

Door status output: SPDT rated: 0.2A/12VDC



The armature plate is covered by a plastic housing.

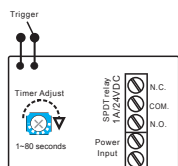

**xxxxx-TD:** Relock time delay  
A built-in timer allows a relocking time delay which is adjustable from 1 to 80 seconds.

### Standard Installation

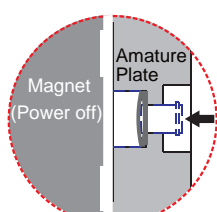
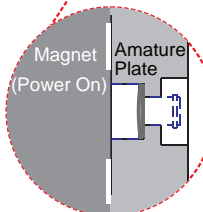
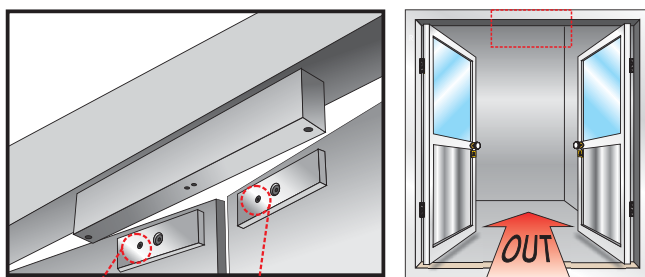

#### Anti-Residual Magnetism design

Our electromagnet locks feature Anti-Residual Magnetism (ARM) which ensures the door can be opened without any resistance from leftover magnetism imparted to the armature plate.

### Optional Brackets

A appropriate bracket complements the magnetic lock. Brackets are selected according to the direction of door swing, the thickness of door frame and the materials of the doors.

**Outswing doors:** L-brackets are recommended for narrow frame doors.

When the door frame thickness (marked 'A') is less than 42 mm L-GEM-D600 bracket should be used to enable installation.

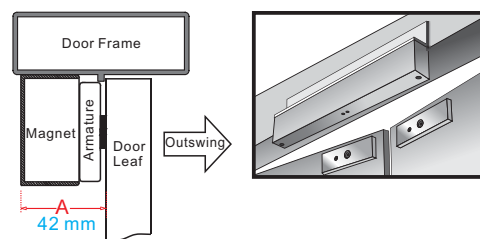

The mounting plate should be screwed to the L-bracket prior to installing the L-bracket. After the L-bracket is installed the magnet can then be screwed to the L-bracket.

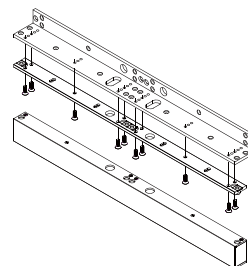

L-GEM-D600

**Inswing doors:** LZ-brackets are recommended for doors that open inwards.

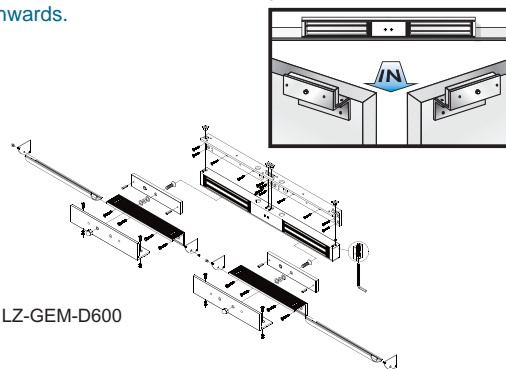

LZ-GEM-D600

**U-bracket for frameless glass doors**  
UBK-013 For 10~12mm thickness of glass door

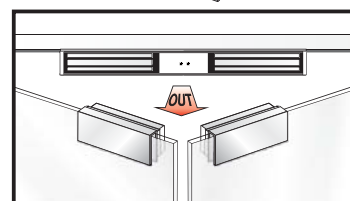

GIANNI INDUSTRIES, INC.