

Automatic door systems for the demarcation of buildings and objects in closed fire compartments for the protection of people and valuables.

Automatic door systems consist of triggering devices and locking devices.

In the event of a fire, the signals created by the automatic triggering device cause the release of the locking device. The actuation by the manual triggering device also leads to a release of the locking device.

The fire doors close and prevent the spreading of fires and of any present smoke to bordering areas of the building. In this way, fire and dangerous fire aerosols are contained and human life as well as valuables are protected.

The locking device consists of e.g. clamping magnet with corresponding anchor plate and/or of an automatic door closer. The triggering device consists of the smoke protection switch, fire detector and release key (manual triggering device).

In terms of building authorities, automatic door systems are subject to the Deutschen Institut for Bautechnik in Berlin and need a system authorization (for this, see certificates of approval from the DIBt).

Arrester system for fire barriers
Authorization number: Z-6.5-430

System SAL 9000 FSA Smoke Heat Ventilation Module
Authorization number: Z.-6.5-1457

System 8000 FSA system authorization
Authorization number: Z-6.5-1764

System IQ8FSA 8619 system authorization
Authorization number: Z-6.5-1759

System 8000 FSA Plus system authorization
Authorization number: Z-6.5-1808



For stand-alone operation in connection with FSA transponder (part no. 808619.10) IQ8Quad detectors can be used as arrester system detectors without loop isolators (part no. 803371, 803271, 803374).

Connection examples

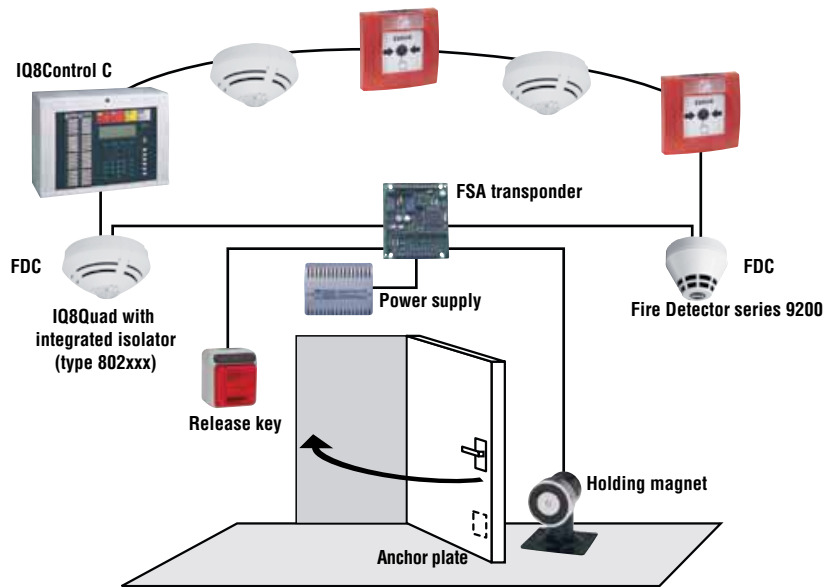

Door release functionality by detectors series 9200 or IQ8Quad as a release element on the esserbus®

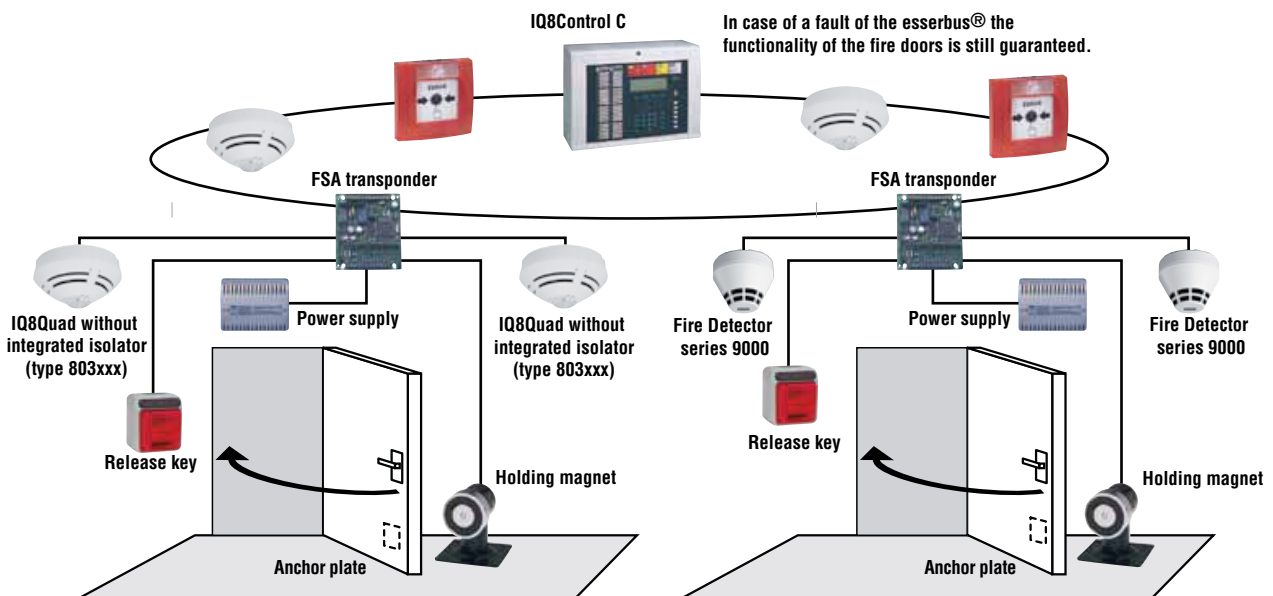

Preventive fire protection with several doors and the FSA transponder on esserbus

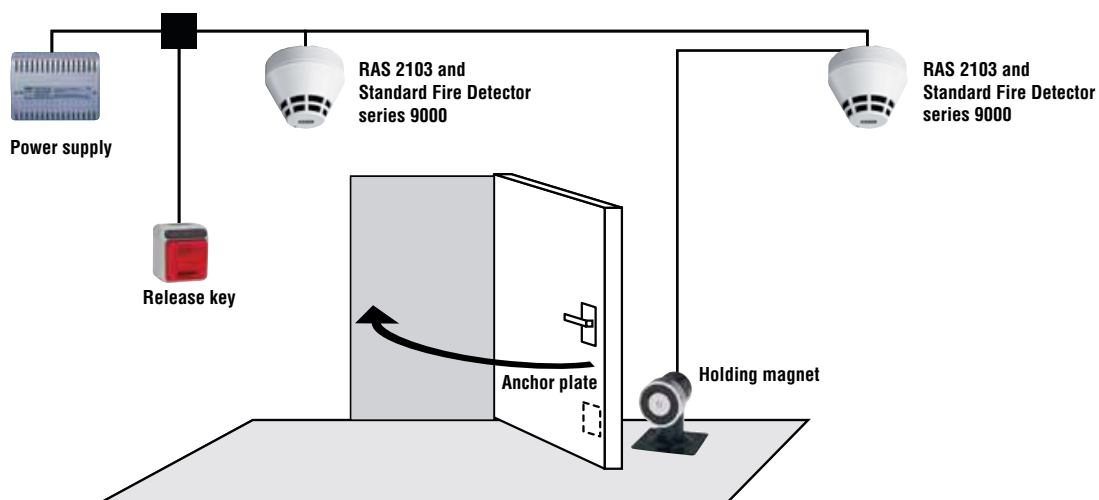

RAS 2103 Smoke Heat Ventilation Module as a stand alone solution with two standard fire detectors

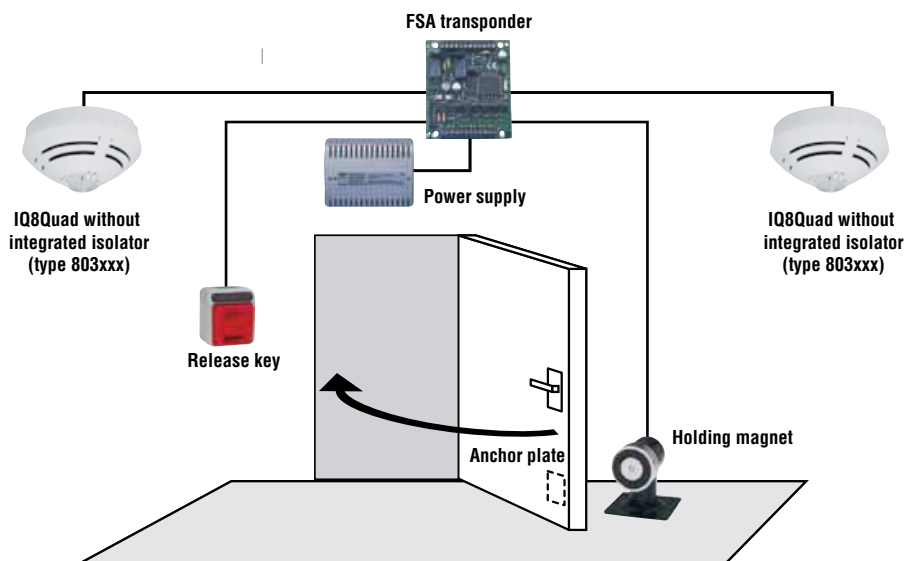

FSA transponder as a stand alone solution with two standard fire detectors without isolator

Smoke Heat Ventilation Modules

782103



Detector base for door release system type RAS 2103



Detector base for door release system type RAS 2103 is used for direct activation of locking devices in compliance with the regulations of the German Institute for Building Technique (DIBt). For power supply, power supply units 765612 and 765624 are required.

Technical Data

Operating voltage	9 ... 28 V DC
Quiescent current	approx. 25 mA (RAS with detector)
Contact load relay	50 V DC/1 A
Ambient temperature	-20 °C ... 70 °C
Storage temperature	-25 °C ... 85 °C
Type of protection	IP 40 with detector, IP 42 with installation plate
Material	ABS plastic
Color	white, similar to RAL 9010
Weight	approx. 60 g
Dimensions	Ø: 89 mm H: 22 mm

 The RAS 2103 may be operated with the following conventional fire detectors:

- Rate-of-rise heat detector 761262 (series 9000)
- Optical smoke detector 761362 (series 9000)

Power Supply Units for RAS 2103

765612



Power supply unit (12 V / 3A) for automatic door release systems



Surface mount cabinet for fire door release systems.

Technical Data

Rated voltage	230 V AC/115 V AC
Rated frequency	50 ... 60 Hz
Output voltage	12 V DC
Output current	max. 3 A
Ambient temperature	-10 °C ... 40 °C
Storage temperature	-20 °C ... 85 °C
Air humidity	≤ 95% (without condensation)
Type of protection	IP20
Housing	ABS plastic
Color	white, similar to RAL 9010
Weight	approx. 800 g
Dimensions	W: 195 mm H: 140 mm D: 70 mm

765624



Power supply unit (12 V / 3A) for automatic door release systems

As 765612 but



Technical Data

Output voltage	24 V DC
Output current	max 1.5 A
Air humidity	≤ 95% (without condensation)
Housing	ABS plastic
Color	white, similar to RAL 9010

Release Keys

767813.10



Surface mount release key for automatic door - arrester system, German

NEW



Surface mount release key for manual actuation of locking devices with double rocker switch insert.

Technical Data

Contact load	250 V AC/10 A
Type of protection	IP 44
Housing	ABS plastic
Color	grey, similar to RAL 7035
Weight	approx. 120 g

767814.10



Flush mount release key for automatic door arrester system, German

NEW



Flush mount release key for manual actuation of locking devices with double rocker switch insert.

Technical Data

Contact load	250 V AC/10 A
Type of protection	IP 44
Housing	ABS plastic
Color	white
Weight	approx. 95 g



DIBt approved for:
 SHV module RAS 2103 : Z-6.5-1457
 Automatic door arrester system: Z-6.5-430
 Fire alarm system 8000 FSA: Z-6.5-1764
 FSA transponder: Z-6.5-1759

Holding Magnets

The door retainer magnets from this product line are generally vacuum cast and display IP65 protection class from the basic device. The magnets are quality-controlled and are subjected to a sampling twice per year by the VdS. In addition, all dimensions are in accordance with European specifications and tested in compliance with the EN1155.

767010



Door Retainer DH50-N490-WM

NEW



Door retainer with polarity reversal protection and connecting terminal including fixing plate for wall mounting.

Technical Data

Operating voltage	24 V DC
Power consumption	1.5 W
Holding power	490 N
Dimensions	Ø: 50 mm H: 30 mm

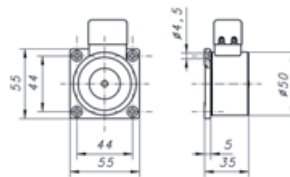

767011



Door Retainer DH70-N1372-WM

NEW



Same as 767010 but with 1372 N of holding power and additional contact box IP65.

Technical Data

Operating voltage	24 V DC
Power consumption	1.5 W
Holding power	1372 N
Dimensions	Ø: 70 mm H: 35 mm

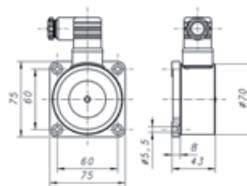

767012



Door Retainer DH50-N490-WM

NEW



Same as 767010 but with steel fixing plate for usage with locking devices on sliding doors.

Technical Data

Operating voltage	24 V DC
Power consumption	1.5 W
Holding power	490 N
Dimensions	Ø: 50 mm H: 35 mm

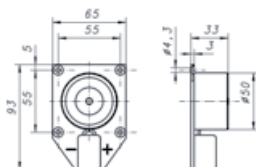

767013



Door Retainer DH50-N490-WM

NEW



Door retainer for wall mounting with polarity reversal protection, terminal and manual release key for rear cabling.

Technical Data

Operating voltage	24 V DC
Power consumption	1.5 W
Holding power	490 N
Dimensions	W: 105 mm H: 85 mm D: 37.5 mm

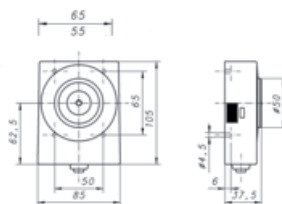

767014



Door Retainer DH50-N490-WM

NEW



Same as 767013 but with additional screwed cable gland.

Technical Data

Operating voltage	24 V DC
Power consumption	1.5 W
Holding power	490 N
Dimensions	W: 105 mm H: 85 mm D: 37.5 mm

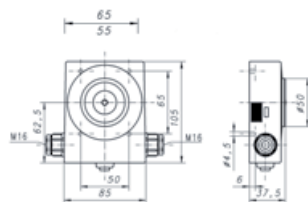

767015



Door Retainer DH50-N490-GM

NEW



Door retainer with aluminum bracket for base mounting.

Technical Data

Operating voltage	24 V DC
Power consumption	1.5 W
Holding power	490 N
Dimensions	W: 109 mm H: 121 mm D: 86 mm

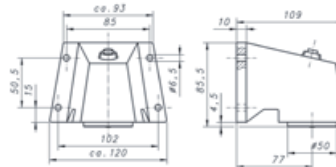

767016



Door Retainer DH70-N1372-GM

NEW



Same as 767015 but with 1372 N of holding power and plastic bracket.

Technical Data

Operating voltage	24 V DC
Power consumption	1.5 W
Holding power	1372 N
Dimensions	W: 109 mm H: 121 mm D: 86 mm

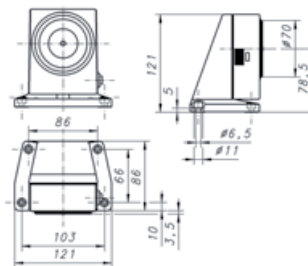

767017



Door Retainer DH50-N490-UM

NEW



Door retainer optionally suitable for base, ceiling and wall mounting. The anodized aluminium swivel head can be changed from wall to base and/or ceiling mounting. The tube can be shortened to 110 and/or 145 mm (base / wall mounting).

Technical Data

Operating voltage	24 V DC
Power consumption	1.5 W
Holding power	490 N
Dimensions	W: 90 mm H: 80 mm D: 150 mm (Groundmounting) W: 90 mm H: 80 mm D: 185 mm (Wallmounting)

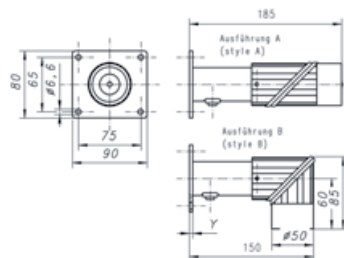

767018



Door Retainer DH50-N490-UM

NEW



Same as 767017 but with base length 300/ 335 mm.

Technical Data

Operating voltage	24 V DC
Power consumption	1.5 W
Holding power	490 N
Dimensions	W: 90 mm H: 80 mm D: 300 mm (Groundmounting) W: 90 mm H: 80 mm D: 335 mm (Wallmounting)

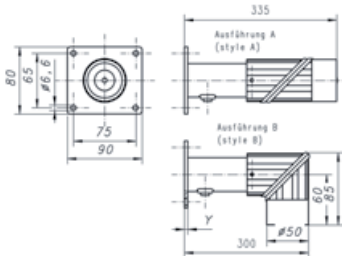

767019



Door Retainer DH50-N490-UM

NEW



Same as 767017 but with base length 450/ 485 mm.

Technical Data

Operating voltage	24 V DC
Power consumption	1.5 W
Holding power	490 N
Dimensions	W: 90 mm H: 80 mm D: 450 mm (Groundmounting) W: 90 mm H: 80 mm D: 485 mm (Wallmounting)

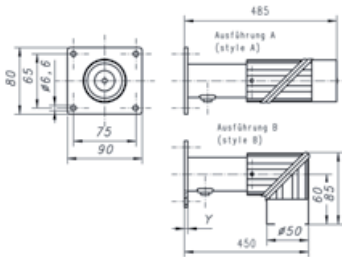

767020



Door Retainer DH70-N1372-UM

NEW



Door retainer exclusively for wall mounting with holding power of 1372 N.

Technical Data

Operating voltage	24 V DC
Power consumption	1.5 W
Holding power	1372 N
Dimensions	W: 90 mm H: 80 mm D: 150 mm (Wallmounting)

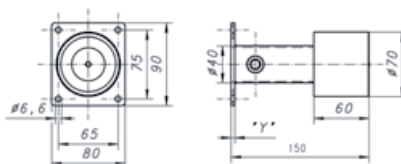

For Ex-Area

767153



Ex holding magnet



Technical Data

Operating voltage	24 V DC
Power consumption	3 W
Holding power	1568 N
Ambient temperature	0 °C ... 35 °C
Ex-category	II 2G
Explosion protection	EExme II T6
Type of protection	IP 54
EC-type examination certificate	TÜV01 ATEX 1778 X



The anchor plate is not supplied as standard.

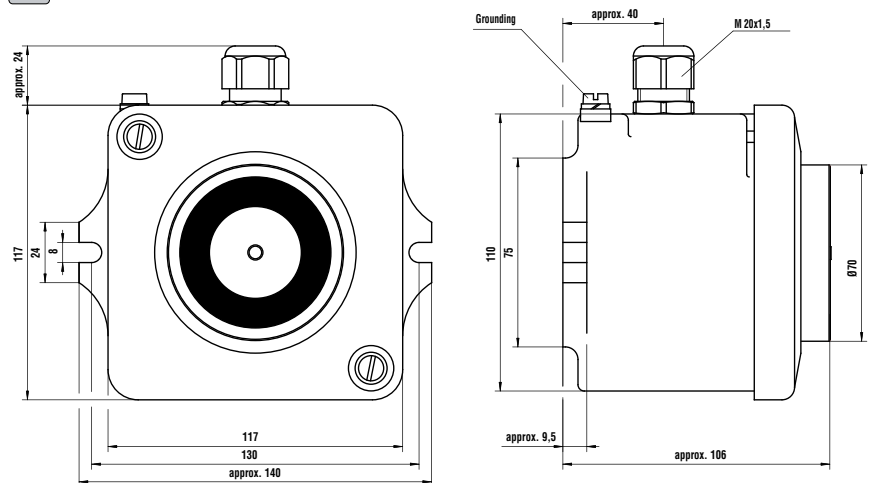

Dimension Drawing

Anchor Plates

The door retainer magnets from this product line are generally vacuum cast and display IP65 protection class from the basic device. The magnets are quality-controlled and are subjected to a sampling twice per year by the VdS. In addition, all dimensions are in accordance with European specifications and tested in compliance with the EN1155.

767030



Anchor Plate DH50-AP-S

NEW



Fixing plate for door retainers with a diameter of 50 mm.

Technical Data

Dimensions	W: 55 mm H: 55 mm D: 18 mm
------------	----------------------------

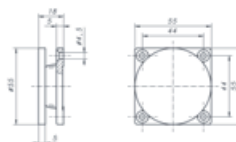

767031



Anchor Plate DH70-AP-S

NEW



Anchor Plate for door retainers with a diameter of 70 mm.

Technical Data

Dimensions W: 75 mm H: 75 mm D: 26 mm

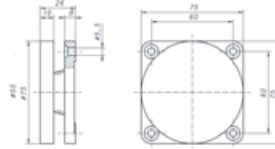

767032



Anchor Plate DH70-AP-SX

NEW



Same as 767031 but for usage within areas at risk of explosions (Ex areas).

Technical Data

Dimensions W: 75 mm H: 75 mm D: 26 mm

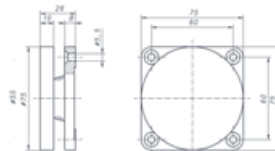

767033



Anchor Plate DH50-AP-M

NEW



Anchor plate with angle setting for door retainers with 50 mm diameter. This model is designed for applications in which there is an angle of contact of the door. The anchor plate is adjustable and mountable by 60° settings into the respective direction through the hinge.

Technical Data

Dimensions W: 55 mm H: 55 mm D: 50 mm

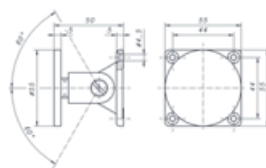

767034



Anchor Plate DH70-AP-M

NEW



Same as 767033 but for door retainers with 70 mm diameter.

Technical Data

Dimensions W: 75 mm H: 75 mm D: 56 mm

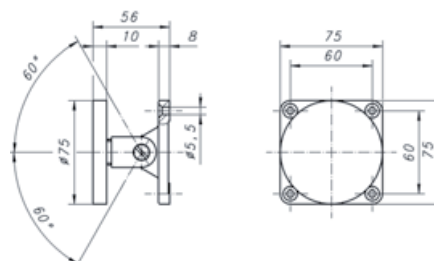

767035



Ex Anchor Plate DH70-AP-MX

NEW



Same as 767034 but for usage within areas at risk of explosions (Ex areas).

Technical Data

Dimensions W: 75 mm H: 75 mm D: 56 mm

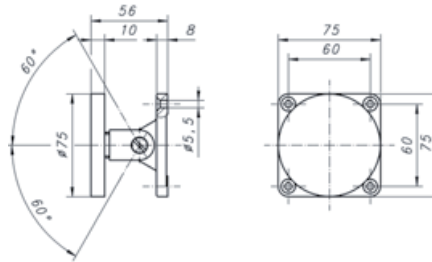

767036



Anchor Plate DH50-AP-A

NEW



Telescopic anchor plate for door retainers with 50 mm diameter. The actual plate is cushioned by means of a built-in spring (spring deflection approx. 20 mm). This is advantageous with heavy doors and/or sliding doors in order to reduce possible impacts and to protect the door retainer and doors from damage. The stop position shouldn't be more than 5°.

Technical Data

Dimensions W: 55 mm H: 55 mm D: 79 mm

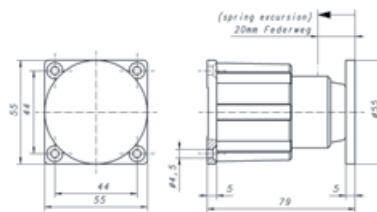

767037



Anchor Plate DH70-AP-A

NEW



Same as 767036 but for door retainers with 70 mm diameter.

Technical Data

Dimensions W: 75 mm H: 75 mm D: 84 mm

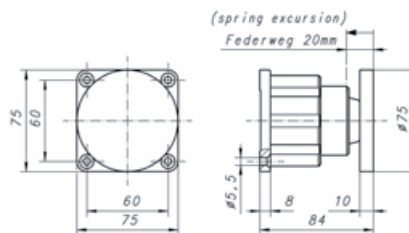

767038



EX Anchor Plate DH70-AP-AX

NEW



Same as 767037 but for usage within areas at risk of explosions (Ex areas).

Technical Data

Dimensions W: 75 mm H: 75 mm D: 84 mm

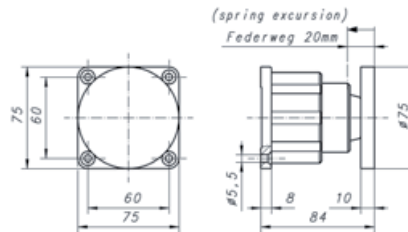

Door Closer



DIBt approved for:

Fire door module RAS 2103 : Z-6.5-1457

Automatic door arrester systems for fire barriers: Z-6.5-430

Fire detection system 8000 FSA: Z-6.5-1764

FSA-transponder: Z-6.5-1759

767123



Door closer, hold-open size 2-5

Slide bar with integrated, electromechanical hold-open device. Opening angle (80° to 130°) and adjustable release force.



Technical Data

Operating voltage	24 V DC
Power consumption	1.4 W
Color	silver
Weight	approx. 3.5 kg
Dimensions	L: 275 mm W: 53 mm H: 60 mm



DIBt zugelassen für:

Rauchalarmschalter RAS 2103:Z-6.5-1457

Feststellanlagen für Feuerschutzabschlüsse:Z-6.5-430

Brandmeldesystem 8000 FSA:Z-6.5-1764

FSA-Koppler:Z-6.5-1759



on demand

767140



Door closer, hold-open size 5-7

As 767123 but with maximum door width of 1600 mm.



Technical Data

Operating voltage	24 V DC
Power consumption	1.4 W
Color	silver
Weight	approx. 5.2 kg
Dimensions	L: 285 mm W: 62 mm H: 71 mm



Please note that the manufacturer recommends applying external holding magnets when using door closer sizes 5–7 instead of applying an integrated hold-open device within the door closer.



on demand

767129



Door closer, hold-open and co-ordinator size 2-5

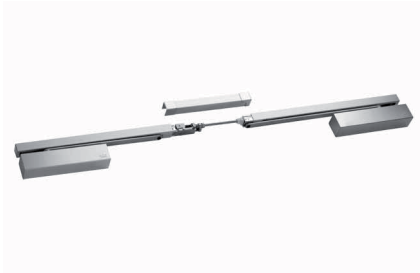

Guide rail door closer TS 93 GSR-EMF 2 (BG), EN 2-5, for a two-panel door in contour design with tapered opening angle for easy door opening, with closing sequence control G-GSR-EMF 2, with integrated electromechanical hold-open device in both leading and trailing panel, mounting on the hinge, silver.

Technical Data

Operating voltage	24 V DC
Power consumption	1.4 W
Color	silver
Weight	approx. 3.5 kg
Dimensions	L: 275 mm W: 53 mm H: 60 mm

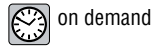

767122



Door closer, hold-open and co-ordinator size 2-5



As 767129 but maximum door width of 1600 mm.

Technical Data

Operating voltage	24 V DC
Power consumption	1.4 W
Color	silver
Weight	approx. 3.5 kg
Dimensions	L: 275 mm W: 53 mm H: 60 mm

Please note that the manufacturer recommends applying external holding magnets when using door closer sizes 5 –7 instead of applying an integrated hold-open device within the door closer.

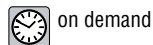

767130



Door closer, co-ordinator size 5-7



As 767129 but with hold open device integrated in the stationary wing.

Technical Data

Operating voltage	24 V DC
Power consumption	1.4 W
Color	silver
Weight	approx. 5.2 kg
Dimensions	L: 285 mm W: 62 mm H: 71 mm

Please note that the manufacturer recommends applying external holding magnets when using door closer sizes 5 –7 instead of applying an integrated hold-open device within the door closer.

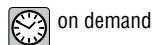

767131



Door closer, co-ordinator size 2-5

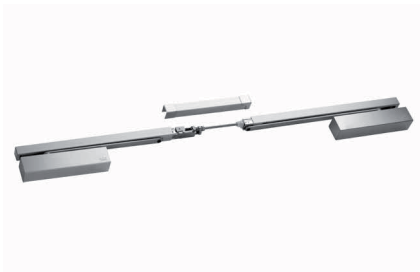

Guide rail door closer TS 93 GSR-EMF 2 (BG), EN 2-5, for a two-panel door in contour design with tapered opening angle for easy door opening, with closing sequence control G-GSR-EMF 2, with integrated electromechanical hold-open device in both leading and trailing panel, mounting on the opposite hinge, silver.

Technical Data

Operating voltage	24 V DC
Power consumption	1.4 W
Color	silver
Weight	approx. 3.5 kg
Dimensions	L: 275 mm W: 53 mm H: 60 mm

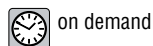

Accessories

767120



Mounting plate for door closer with door closer control

For mounting the slide bar to doorframes, where direct mounting is not suitable.



2x mounting plate

767121



Mounting plate for door closer without door closer control

For mounting the slide bar to doorframes, where direct mounting is not suitable.



767800



Mounting bracket for lintel installation

Mounting bracket for all bases/detectors of the IQ8Quad group, series 9x00, RAS 2103 and for IQ8Alarm & all alarm devices.

The distance between the mounting holes is 6 cm and the diameter is approx. 5 mm.



Technical Data

Color white, similar to RAL 9010

Mounting bracket and material

796094



FSA label

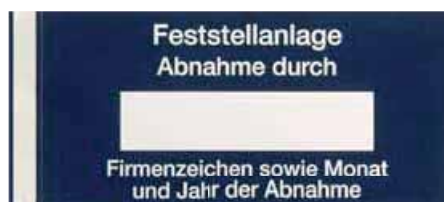

796349



Label for release push button

Red sticker label for release key button 767813 and 767814.

10 pcs

